

# Technical Service Bulletin

**NUMBER:** 23-46-99

**GROUP:** Body

**DATE:** Nov. 5, 1999

*This bulletin is supplied as technical information only and is not an authorization for repair. No part of this publication may be reproduced, stored in a retrieval system, or transmitted, in any form or by any means, electronic, mechanical, photocopying, recording, or otherwise, without written permission of DaimlerChrysler Corporation.*

## **SUBJECT:**

High Effort Required To Adjust The Front Seats Forward From The Rear Position.

## **OVERVIEW:**

This bulletin involves replacing the front seat tracks and installing an assist spring to each front seat.

## **MODELS:**

2000 (PL) Neon

**NOTE: THIS BULLETIN APPLIES TO VEHICLES BUILT PRIOR TO AUGUST 2, 1999 (MDH 0802XX).**

## **SYMPTOM/CONDITION:**

Reports of high efforts to adjust the front seat forward from a rearward position. This is caused by excessive friction from the seat track rollers.

## **DIAGNOSIS:**

If customer complains of high efforts to adjust the front seat forward perform the Repair Procedure using the seat track kit.

## **PARTS REQUIRED:**

1 05017605AA Seat Track Adjuster Kit

Seat Track Kit contents:

2	04864865	Bolt, Seat Belt Buckle
2	04680045	Rubber Bushing, Seat Belt Buckle Bolt
2	05017596AA	Wire, Seat Adjuster
2	05017595AA	Spring, Seat Track Adjuster
2	05017602AA	Towel Bar, Seat Adjuster
1	05017598AA	Adjuster, Seat Track (Driver)
1	05017599AA	Adjuster, Seat Track (Driver)
1	05017600AA	Adjuster, Seat Track (Passenger)
1	05017601AA	Adjuster, Seat Track (Passenger)
1	K6853458	Instruction Sheet
6	04746997	Fastener, Reclining Track Bolt
4	04761014	Fastener, Front Track
4	05017779AA	Push Nut

- 2 05017778AA Fastener, Pop Rivet Towel Bar
- 2 05017780AA Fastener, Pivot Bolt

**REPAIR PROCEDURE:**

1. Move the seat to the full forward position.
2. Remove the bolts attaching rear of seat track to the floor.
3. Move seat to the rearward position.
4. Remove bolts attaching front of seat track to floor crossmember.
5. Remove seat from the vehicle.
6. With seat on a bench, remove the seat belt buckle and discard bolt and rubber bushing. Set buckle and washer aside for reuse.
7. Remove the inboard pivot bolt.
8. Remove the two trim cover shield screws and remove the cover.
9. Remove both outboard recliner attachment bolts and set the seat back aside.

**NOTE: PRIOR TO PERFORMING STEP 10, IDENTIFY THE DIFFERENCES BETWEEN THE INBOARD AND OUTBOARD SEAT TRACKS FOR EASE OF INSTALLATION. THE INBOARD TRACK HAS THE INSTALLATION HOLE FOR THE SEAT BELT BUCKLE BOLT.**

10. Remove the 2 bolts holding the seat track to the seat bottom.
11. Repeat for the other track.
12. Install the inboard track and torque the attachment bolts to 11 Nm (105 in. lbs.) (Figure 1).

**CAUTION: DO NOT EXCEED THE TORQUE SPECIFICATION TO THE SEAT TRACKS. EXCEEDING THE TORQUE CAN CAUSE WARPAGE OF THE TRACKS.**

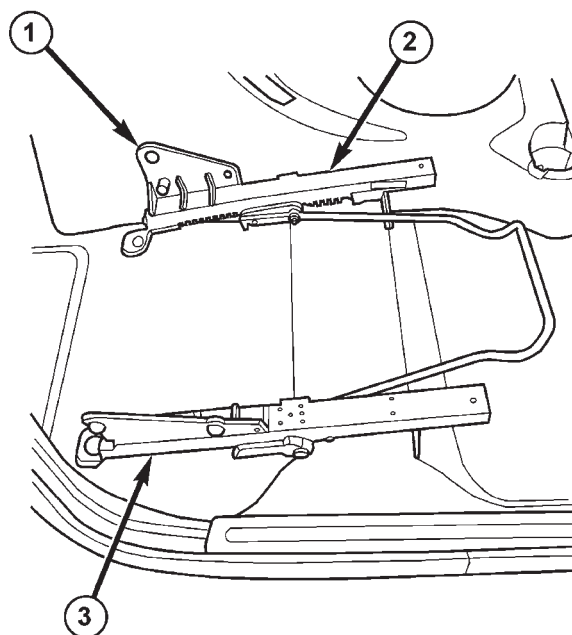

**FIGURE 1**

1-	SEAT BELT BUCKLE ATTACHMENT LOCATION
2-	INBOARD TRACK
3-	OUTBOARD TRACK

13. Position the towel bar on the inboard side and install the rivet provided in the parts kit. Insure that the towel bar is fully seated against the track and install the push nut on the inboard side (Figure 2). Insure the push nut is fully seated to prevent rattling of the towel bar.

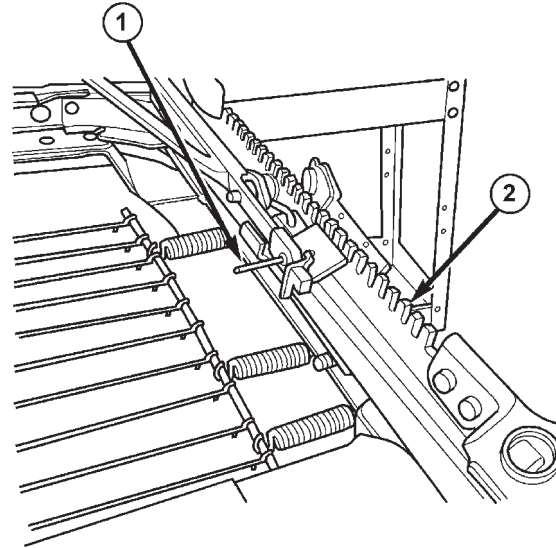

**FIGURE 2**

1-	RIVET
2-	INBOARD TRACK

14. Position the towel bar into the latch plate bracket on the outboard side and position onto the pivot pin. Insure that the towel bar is fully seated against the track and install the push nut (Figure 3).

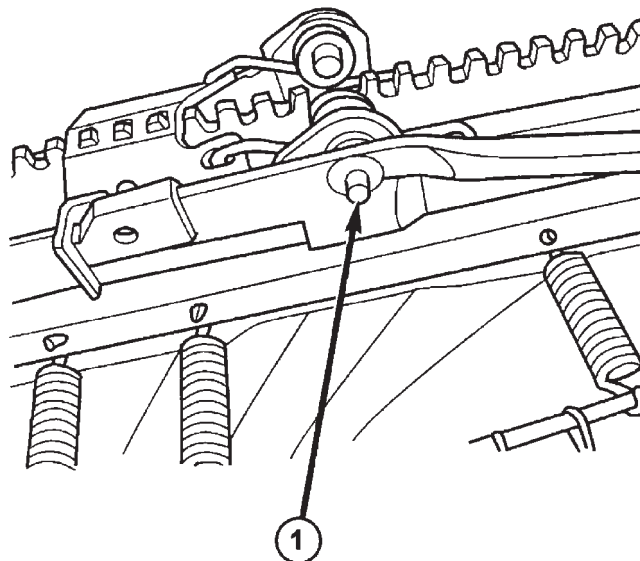

**FIGURE 3**

1-	OUTBOARD TRACK PUSH NUT SHOWN INSTALLED
----	---

15. Install the outboard track and hand tighten the top front bolt
16. Attach the seat back and install the two outboard recliner bolts. Torque the bolts to 28 Nm (250 in.lbs.) (Figure 4).

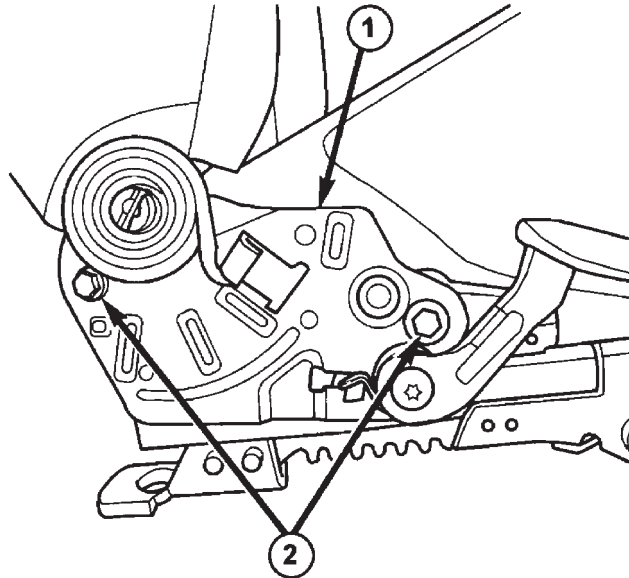

**FIGURE 4**

1-	OUTBOARD RECLINER
2-	OUTBOARD RECLINER BOLTS

17. Torque the top front bolt installed in step 15 to 11 Nm (105 in. lbs.).
18. Install the inboard seat pivot and torque the bolts to 28 Nm (250 in.lbs.).
19. Set both seat tracks to the install position (11 teeth rearward of the latch plate bracket) (Figures 5 & 6).

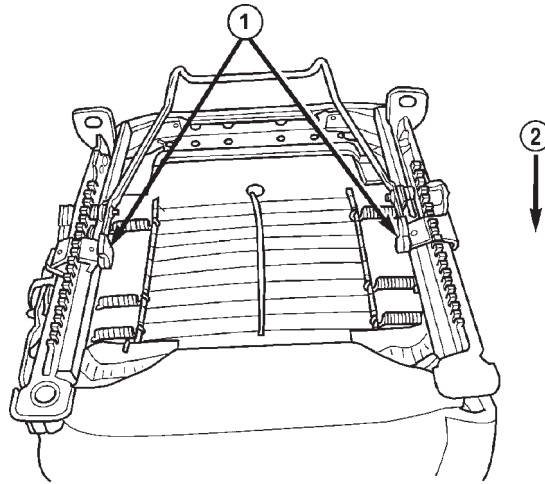

**FIGURE 5**

1-	LATCH PLATE BRACKET
2-	REARWARD

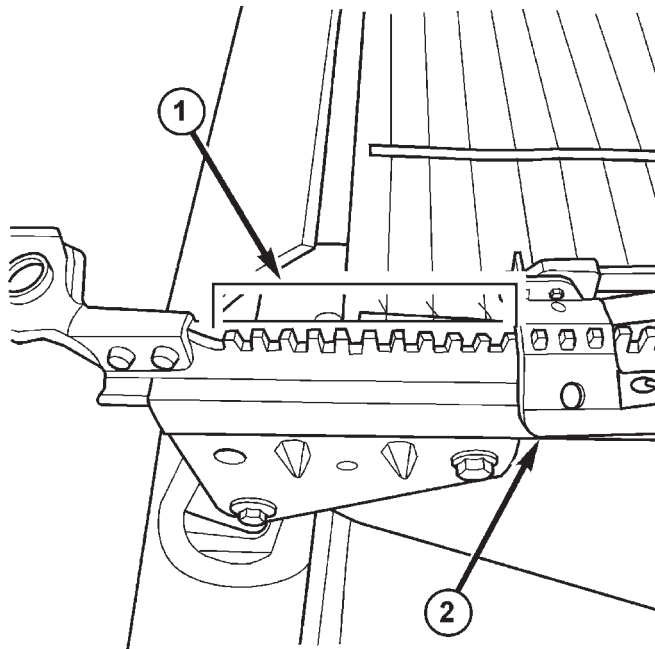

**FIGURE 6**

1-	11 TEETH REARWARD OF LATCH PLATE BRACKET
2-	LATCH PLATE BRACKET

20. Install the assist spring attachment wire into the front of the seat track openings (Figure 7).

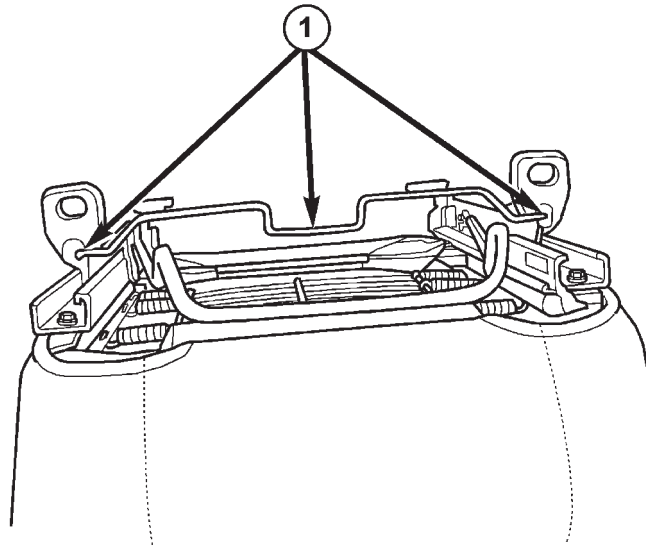

**FIGURE 7**

1-	ASSIST SPRING ATTACHMENT WIRE SHOWN INSTALLED
----	---

21. Ensure that the assist spring anti BSR sleeve is on the assist spring. Attach the assist spring to the rear of the seat pan on the inboard side hog ring hole (Figure 8).

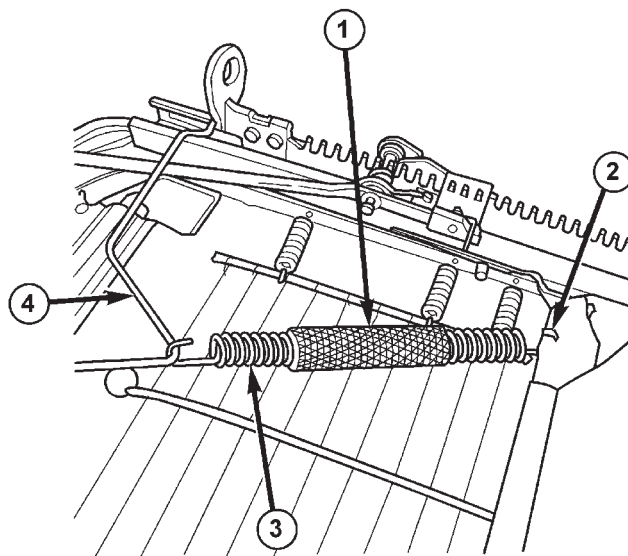

**FIGURE 8**

1-	ASSIST SPRING ANTI-BSR SLEEVE
2-	ASSIST SPRING INBOARD SIDE HOG RING HOLE
3-	ASSIST SPRING
4-	ASSIST SPRING ATTACHMENT WIRE

**CAUTION: ENSURE THAT THE END OF THE ASSIST SPRING HOOK IS FACING DOWNWARD AWAY FROM THE SEAT (FIGURE 8).**

22. Stretch the assist spring and attach to the attachment wire (Figure 8).
23. Ensure that the assist spring attachment wire is fully seated against the front of the seat track.
24. Install the trim cover shield.
25. Install the seat belt buckle using the new rubber bushing (p/n 04680045) and new bolt (p/n 04864865) provided in the parts kits (Figure 9). Torque the bolt to 39 Nm (350 in.lbs.). The seat belt buckle and washer is reused from the original assembly.

**CAUTION: WHEN INSTALLING THE SEAT BELT BUCKLE, ENSURE THAT THE BUCKLE IS PROPERLY POSITIONED AND THE TORQUE IS REACHED.**

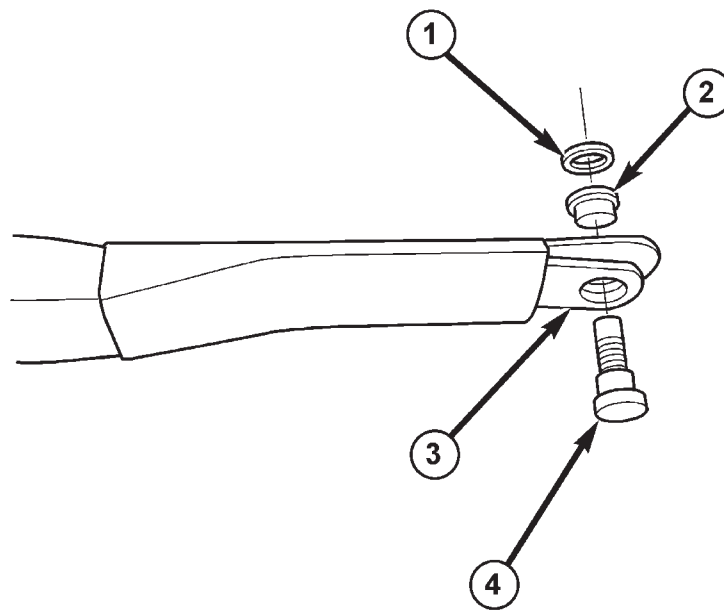

**FIGURE 9**

1-	WASHER
2-	RUBBER BUSHING
3-	SEAT BELT BUCKLE
4-	BOLT

26. Verify that both seat tracks are locked into the same position with 11 teeth behind the latch mechanism.
27. Move the seat into position in the vehicle. Use caution while inserting the seat into the vehicle, as the seat tracks can cause damage to the trim. Do not use the head restraint, side shield, recliner handle or the adjuster bar to lift the seat, as this will cause damage to the components.



**CAUTION: TIGHTEN ALL MOUNTING BOLTS TO FULL TORQUE BEFORE ADJUSTING SEAT TRAVEL.**

- 28. Ensure that the locating tabs on the front mounting feet are installed through the slits in the carpet and into the openings in the floor pan crossmember.
- 29. Install and tighten the front inboard bolt attaching seat track to floor crossmember. Tighten all front seat bolts to 55 Nm (40 ft.lbs) torque.
- 30. Install front outboard bolt attaching seat track to floor crossmember. Tighten all front seat bolts to 55 Nm (40 ft. lbs.) torque.
- 31. Install the rear inboard, then the rear outboard seat track attaching bolts to floor. Tighten all rear seat bolts to 55 Nm (40 ft. lbs.) torque.
- 32. Install the seat belt latch plate into the seat belt buckle to ensure proper engagement and positioning of the buckle.
- 33. Cycle the seat to ensure the seat functions backwards and forwards.
- 34. Repeat steps 1 through 33 for other front seat.

**POLICY:** Reimbursable within the provisions of the warranty.

**TIME ALLOWANCE:**  
Labor Operation No: 23-13-35-96 ..... 1.2 Hrs.

**FAILURE CODE:** P8 – New Part